



Master Cylinders (MC):
External dimensions & Installation detail

Cilindros Maestros (CM):
Dimensiones exteriores y detalles de instalación



External dimensions & Installation detail

Dimensiones exteriores y detalles de instalación

PUSH ROD TYPE				
<p>Type I</p>	<p>Type II</p>	<p>Type III</p>	<p>Type IV</p>	<p>Type V</p>

INSTALLATION TYPE				
<p>Type I</p>	<p>Type II</p>	<p>Type III</p>	<p>Type IV</p>	<p>Type XVI</p>

MASTER CYLINDER (BODY) TYPE				
<p>Type I</p>	<p>Type II</p>	<p>Type III</p>	<p>Type IV</p>	
<p>Type V</p>	<p>Type VI</p>	<p>Type VII</p>	<p>Type VIII</p>	
<p>Type IX</p>	<p>Type X</p>	<p>Type XI</p>	<p>Type XII</p>	
<p>Type XIII</p>	<p>Type XIV</p>	<p>Type XV</p>	<p>Type XVI</p>	
<p>Type XVII</p>	<p>Type XVIII</p>	<p>Type XIX</p>		



Single Master Cylinders (SMC) Cilindros Maestros Simples (CMS)

The listed products make up our standard range. ***We are always prepared to consider special product requests, being able to adapt to low volume production if necessary.***

Los productos a continuación descritos son nuestro estandar.

Estamos preparados a considerar productos especiales solicitados por el cliente, para medianas y bajas series.

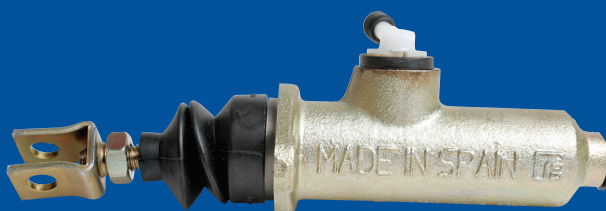
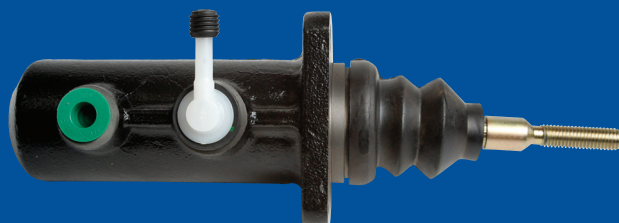
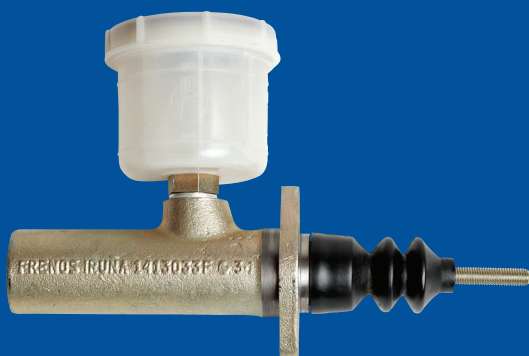
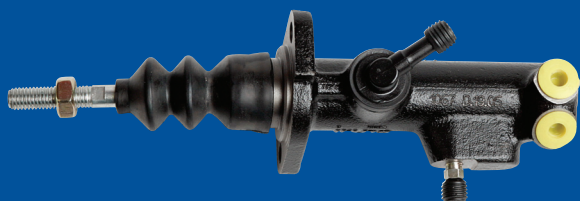

Functional data				External Dimensions		Installation			Body	Fluid Inlet	Fluid Outlet	Push Rod			Fluid type	Part Number
Bore Ø		Stroke	Vol. MIN.	L	D	Type	Hole Ø x separation		Type	Type / size	Type / size	Type	Size	Lp	Note 2.	
mm	inches	mm	cc	mm	mm		Ømm	mm						mm		
38.1	1 1/2"	35	39.5	140	54	IV	Ø 11	86	I	Pipe Ø 7,37	9/16"-18 UNF	II	M10/150	96	M	6300200
22.22	7/8"	46	5.5	123,5	33	II	Ø 9	60	XIX	Pipe Ø 7,37	M12/100	II	M8/125	96	M	6300198
22.22	7/8"	25	9.7	128	39	II	Ø 8,8	60	XIV	Pipe Ø 7,37	M10/100	IV	-	83	M	6300187
22.22	7/8"	25	9.7	128	39	II	Ø 8,8	60	XIV	Pipe Ø 7,37	M10/100	IV	-	83	V	6300186
22.22	7/8"	16	5.5	123,5	40	II	Ø 8,8	60	XIII	M22/150	M12/100	II	M8/125	70,8	M	6300182
22.22	7/8"	36	13.2	107	30	II	Ø 9	57	I	M12/100	M12/100	II	5/16" UNF	98	M	6300180
25.4	1"	36	16.7	126	44	I	Ø 11	82	I	Pipe Ø 7,37	7/16"-20 UNF	I	Ø 10 W = 8,8	111	M	6300178
15.87	5/8"	36	6.7	107	30	II	Ø 6,5	50	II	RESERVOIR	M12/100	IV	M8/125	15	M	6300158
19.05	3/4"	33	8.9	134	32	I	Ø 8,5	60	XIII	Pipe Ø 11	M10/100	I	Ø 8 W = 8,8	114	V	6300177
15.87	5/8"	36	6.7	107	30	II	Ø 9	57	II	M12/100	M12/100	II	5/16" UNF	96	M	6300124
17.75	7/10"	36	8.4	107	30	II	Ø 9	57	II	M12/100	M12/100	II	M 8 x 1,25	101	M	6300120
17.75	7/10"	36	8.4	107	30	II	Ø 9	57	II	7/16-20 UNF	3/8-24 UNF	II	5/16" 24-UNF	101	V	6300068
17.75	7/10"	30	6.9	130	31	II	Ø 9	57	I	Pipe Ø 16	3/8" UNF	II	5/16" UNF	128	V	6300074
19.05	3/4"	36	9.7	107	30	II	Ø 9	57	II	M12/100	M12/100	II	5/16" UNF	96	M	6300000
19.05	3/4"	30	8	120	39	II	Ø 9	57	I	Pipe Ø 7,37	3/8" UNF	I	Ø 8 W = 8,8	74	M	6300053
19.05	3/4"	36	9.4	117	37	I	Ø 9	60	I	M16/150	M10/100	III	28	-	V	6300112
19.05	3/4"	30	8	118	37	I	Ø 9	60	I	Pipe Ø 7,37	M10/100	I	10	85	V	6300040
19.05	3/4"	36	9.4	130	30	II	Ø 9	57	II	RESERVOIR	M10/100	II	W = 11 3/8" UNF	110	V	6300037
19.05	3/4"	25	6.56	131	30	V	Ø 8,5	F:76.5 G/H:22/28	I	Pipe Ø 14	M10/100	I	Ø 8	106	V	6300145
19.05	3/4"	30	8	118	36	I	Ø 9	60	I	Pipe Ø 7,37	M10/100	II	W = 11 M8 x 125	71	V	6300161
22.22	7/8"	36	13.2	1007	30	II	Ø 9	57	II	M12/100	M12/100	II	3/8" UNF	110	M	6300005
22.22	7/8"	36	13.2	126	35	II	Ø 9	57	I	RESERVOIR	M12/100	II	5/16" UNF	96	M	6300077
22.22	7/8"	36	13.2	126	39	II	Ø 9	57	I	RESERVOIR	M12/100	II	5/16" UNF	110	M	6300116
22.22	7/8"	36	13.2	134	30	II	Ø 9	57	II	RESERVOIR	M12/100	II	M10 x 150	87	M	6300013
22.22	7/8"	36	13.2	126	39	II	Ø 9	57	I	RESERVOIR	M12/100	II	3/8" UNF	110	M	6300117
22.22	7/8"	36	13.2	126	39	II	Ø 9	57	I	RESERVOIR	M12/100	II	5/16" UNF	96	M	6300119
25.4	1"	36	16.7	115	37	II	Ø 10,5	63,5	II	M14/150	M14/150	II	M 10 x 150	96	M	6300022
25.4	1"	36	16.7	126	45	I	Ø 11	82	I	Pipe Ø 7,37	M12/100	II	M 10 x 150	96	M	6300050
25.4	1"	30	14.2	120	39	II	Ø 9	57	I	Pipe Ø 7,37	3/8" UNF	I	Ø 8 W = 11	84	M	6300054
25.4	1"	36	17.2	104	40	V	Ø 8,5	F:76.5 G/H:22/28	I	Pipe Ø 9	M12/150	I	Ø 8 W = 9	135	M	6300057
25.4	a1"	36	17.2	104	40	V	Ø 8,5	F:76.5 G/H:22/28	I	RESERVOIR	M12/150	I	Ø 8 W = 9	135	M	6300058
28.57	1 1/8"	36	21.1	126	45	I	Ø 11	82	I	Pipe Ø 7,37	M12/100	II	M 10 x 150	120	M	6300010
28.57	1 1/8"	36	21.1	126	45	I	Ø 11	82	I	Pipe Ø 7,37	M12/100	II	M 10 x 150	96	M	6300113
31.75	1 1/4"	36	26.1	126	45	I	Ø 11	82	I	Pipe Ø 7,37	M12/100	III	30	-	M	6300005
31.75	1 1/4"	36	29.3	126	45	I	Ø 11	82	I	Pipe Ø 7,37	M12/100	II	M 10 x 150	84	M	6300015
31.75	1 1/4"	36	29.3	126	45	I	Ø 11	82	I	Pipe Ø 7,37	M12/100	II	M 10 x 150	84	M	6300107
31.75	1 1/4"	40	30.1	135	43	II	Ø 9	72	I	_UNF	_UNF	III	36.5	-	M	6300073
31.75	1 1/4"	36	26.1	126	45	I	Ø 11	82	I	RESERVOIR	M12/100	II	M 10 x 150	108	M	6300123
38.1	1 1/2"	46	50.1	166	52	IV	Ø 10,25	50.8/39	I	_UNF	_UNF	III	29	-	M	6300048
38.1	1 1/2"	25	26.2	110	54	IV	Ø 11	62/66	I	Pipe Ø 7,37	9/16 UNF	II	M 10 x 150	80	M	6300118
41.27	1 5/8"	36	37.6	140	55	IV	Ø 11	32/66	I	Pipe Ø 7,37	9/16 UNF	II	M 10 x 150	123	M	6300144
38.1	1 1/2"	25	25	105	52	V	Ø 11	68	I	Pipe Ø 7	M10/100	II	M 11 x 150	112	M	6300168
19.05	3/4"	30	7.5	141	35	I	Ø 9	60	XI	Pipe Ø 7,37	M10/100 x2	I	Ø 10 W = 11	85	V	6300169
25.40	1"	35	17.7	126	44	I	Ø 11	82	XVI	Pipe Ø 7,37	M12/100	II	M10/150	109	M	6300193
41.27	1 5/8"	25	33.4	114	60	III	Ø 9	90	XVII	Pipe Ø 7,37	M12/150	III	2.8	-	M	6300194



Compensated Master Cylinders (CMC) Cilindros Maestros Compensados (CMC)

The listed products make up our standard range. ***We are always prepared to consider special product requests, being able to adapt to low volume production if necessary.***

Los productos a continuación descritos son nuestro estandar.

Estamos preparados a considerar productos especiales solicitados por el cliente, para medianas y bajas series.

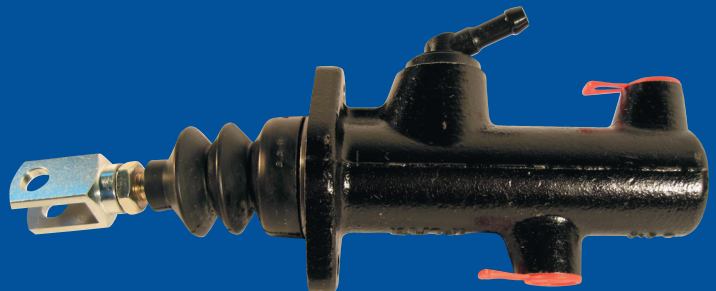
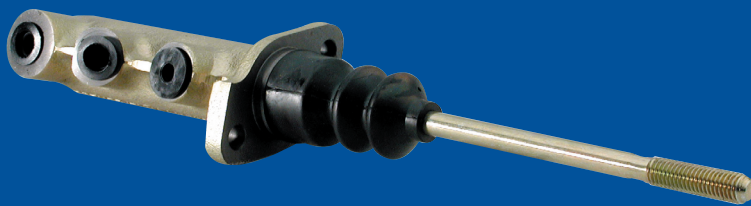

Functional data					External Dimensions		Installation			Body	Fluid Inlet	Fluid Outlet	Compensation	Push Rod			Fluid type	Part Number
Bore Ø		Stroke	Compensation	Vol. MIN.	L	D	Type	Hole Ø, x separation		Type	Type / size	Type / size	Type / size	Type	Size	Lp	Note 2.	
mm	inches	mm	%	cc	mm	mm		Ømm	mm							mm		
19.05	3/4"	36	25	9.5	126.5	33	III	Ø 9	57	V	M12/100	M12/100	M10/100	II	5/16" UNF	96	M	6300016
19.05	3/4"	36	25	9.5	126.5	33	III	Ø 9	57	V	M12/100	M12/100	M10/100	II	M 10 x 150	96	M	6300066
19.05	3/4"	36	33	9.5	126.5	33	III	Ø 9	57	V	M12/100	M12/100	M10/100	II	M 10 x 150	201	M	6300049
19.05	3/4"	36	45	9.8	126.5	33	III	Ø 9	57	V	M12/100	M12/100	M10/100	II	M 10 x 150	201	M	6300149
22.22	7/8"	36	25	13	126.5	33	III	Ø 9	57	V	M12/100	M12/100	M10/100	II	M 10 x 150	201	M	6300028
22.22	7/8"	36	45	13	126.5	33	III	Ø 9	57	V	M12/100	M12/100	M10/100	II	M 10 x 150	201	M	6300147
25.40	1"	36	100	18	97	30	I	Ø 8.5	60	VI	Pipe Ø 7,37	7/16 SME	M10/100	II	M10 x150	150	M	6300151
38.1	1 1/2"	36	100	25	130.5	48	III	Ø 9	90	VII	M14/150	M14/150	M10/100	II	M10 x 150	-	M	6300153(1)
38.1	1 1/2"	39	100	25 / 3	156	48	III	Ø 9	90	VIII	M12/100	M12/100	M10/100	II	M10 x 150	-	M	6300154(2)
15.87	5/8"	36	55	6	125	33	III	Ø 9	57	V	M12/100	M12/100	M10/100	II	M8 x 12.5	101.5	M	6300155
22.22	7/8"	36	45	13	126.5	33	III	Ø 9	57	V	M12/100	M12/100	M10/100	II	M10 x 150	116	M	6300167
22.22	7/8"	36	45	13	126.5	33	III	Ø 9	60	V	M10/100	M10/100	M10/100	III	-	-	M	6300170
19.05	3/4"	33	-	8.8	130	32	I	Ø 8.5	80	IX	M10/100	M10/100	M10/100	I	Ø8 W=9	79	V	6300162
15.75	7/10"	33	-	8.8	130	32	I	Ø 8.5	80	IX	M10/100	M10/100	M10/100	I	Ø8 W=9	194	V	6300163
22.22	7/8"	16	-	5.5	110	36	V	Ø 8.5	F76.5 G/M 22/28	X	M12/150	M12/150	M12/150	I	Ø8 W=9	79	V	6300166
25.40	1"	30	100	13.5	132	36	II	Ø 8	60	XV	M12/125	M12/125	M12/125	I	Ø8 W=9	91	M	6300188
22.22	7/8"	36	45	13	125	33	III	Ø 9	57	XVIII	M12/100	M12/100	M10/100	II	M10 x 150	201	M	6300196



Tandem Master Cylinders (TMC) Cilindros Maestros Tandem (CMT)

The listed products make up our standard range. ***We are always prepared to consider special product requests, being able to adapt to low volume production if necessary.***

Los productos a continuación descritos son nuestro estandar.

Estamos preparados a considerar productos especiales solicitados por el cliente, para medianas y bajas series.

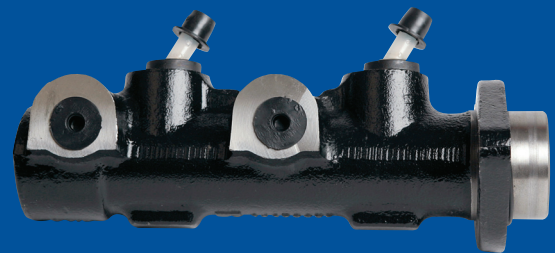
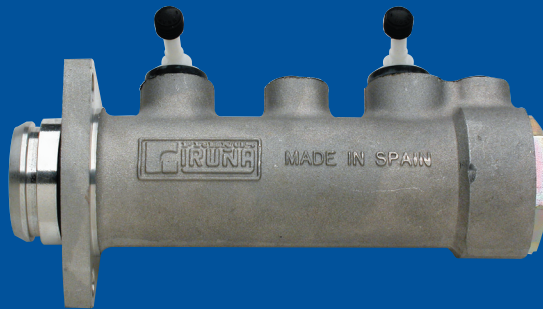

Functional data				External Dimensions		Installation			Body	Fluid Inlet	Fuid Outlet	Push Rod			Fluid type	Part Number
Bore Ø		Stroke	Vol MIN.	L	D	Type	HoleØ, x separation		Type	Type / size	Type / size	Type	Size	Lp	Note 2.	
mm	inches	mm	cc	mm	mm		Ømm	mm								
25.4	1"	35	8.4+8.4	186	42.5	I	Ø 9	82	III	RESERVOIR	M12/100	II	M10/150	108	M	
25.4	1"	35	8.4+8.4	186	42.5	I	Ø 9	60	III	RESERVOIR	M12/100	II	M10/150	108	M	6303017
25.4	1"	35	8.4+8.4	186	37	I	Ø 9	57	III	RESERVOIR	M12/100	II	M10/150	98	M	6303020
25.4	1"	35	9.5+7.2	186	42.5	I	M8/125	61	III	GROMMET	M10/100	III	-0.5 Ø 12	--	V	6301051
28.58	1 1/8"	35	9.5+11.6	186	42.5	I	Ø 11	82	III	PIPE Ø7	M12/100	III	-0.5	--	M	6301004
28.54	1 1/8"	35	10.06+10.6	186	42.5	I	Ø 11	82	III	RESERVOIR	M12/100	II	3/8" UNF	102	M	6303009
38.1	1 1/2"	22	10.3+12.5	195	46.3	IV	Ø 11	62,66	IV	PIPE Ø7.37	M12/100	III	15	--	M	6301056
38.1	1 1/2"	39	21.1+21.1	195	52	IV	Ø 11	62,66	IV	PIPE Ø7.37	M12/100	III	0	--	M	6301041
38.1	1 1/2"	39	21.1+21.1	195	52	IV	Ø 11	62,66	IV	PIPE Ø7.37	M12/100	II	M10/150	108	M	6301061
28.58	1 1/8"	35	10.06+10.6	186	42.5	I	Ø 11	82	III	RESERVOIR	M12/100	II	3/8" UNF	102	V	6303008
31.75	1 1/4"	35	13.01+13.1	186	42.5	I	Ø 11	82	III	RESERVOIR	M12/100	II	3/8" UNF	102	M	6303010
31.75	1 1/4"	35	13.01+13.1	186	42.5	I	Ø 11	82	III	RESERVOIR	M12/100	II	M10/150	108	M	6303016
25.4	1"	35	8.4+8.4	191	41	I	Ø 9	63,5	III	M20/150	1/4" BSP	I	Ø9 W=10	48.3	M	6301063
38.1	1 1/2"	39	21.1+21.1	195	54	IV	Ø 11	Ø 86	III	PIPE Ø7.37	M12/100	II	M10/150	108	M	6301064
38.1	1 1/2"	39	21.1+21.1	195	52	IV	Ø 11	Ø 86	IV	PIPE Ø7.37	M12/100	II	M10/150	115	M	6301065
31.75	1 1/4"	35	12+12	186	42.5	I	Ø 11	82	III	RESERVOIR	M12/100	II	M10/150	108	M	6303021
31.75	1 1/4"	35	12+12	186	42.5	I	Ø 11	82	III	RESERVOIR	M12/100	II	3/8" UNF 1p/Ø/F	102	M	6303023
25.4	1"	36	5.8+10.2	135	35.5	I	Ø 9	82	XX	RESERVOIR	M10/100	V	22.4/42.2/3 0.7	--	V	6303024
25.4	1"	35	6+9.6	190	39.6	I	Ø 11.5	82	III	PIPE Ø7.37	M12/100	II	M10/150	108	M	6301067



Step-Bore Master Cylinders (SBMC) Cilindros Maestros Doble Diámetro (CMDD)

The listed products make up our standard range. ***We are always prepared to consider special product requests, being able to adapt to low volume production if necessary.***

Los productos a continuación descritos son nuestro estandar.

Estamos preparados a considerar productos especiales solicitados por el cliente, para medianas y bajas series.



Functional data				External Dimensions		Installation			Fluid Inlet	Fluid Outlet	Fuid Outlet	Push Rod			Fluid type	Part Number
Bore		Stroke	Vol. MIN.	L	D	Type	Hole Ø, x separation					Type	Size	Lp	Note 2.	
Ø 1	Ø 2						Ømm	mm								
mm	mm	mm	cc	mm	mm				Type / size	Type / size	Type / size			mm		
38.1	25	35	37.6	161	50.5	I	8.5	53	Pipe Ø 7.37	M14x1.5	M14x1.5	I	M10x1.5	82	M	6306001
					43.5											

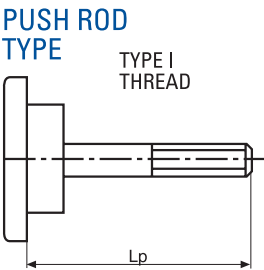
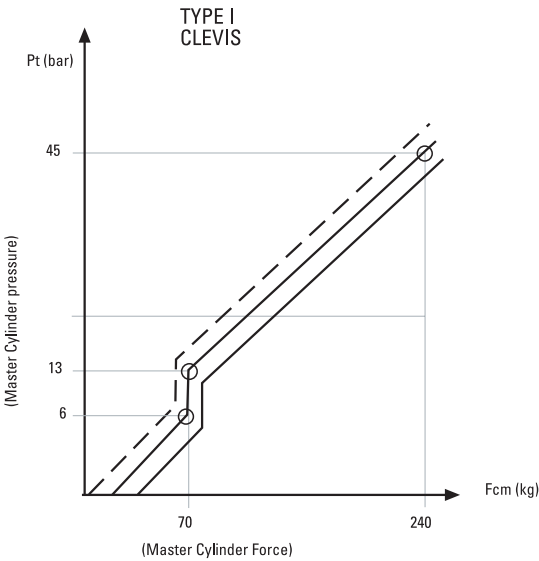

INSTALLATION FLANGE
TYPE

TYPE I

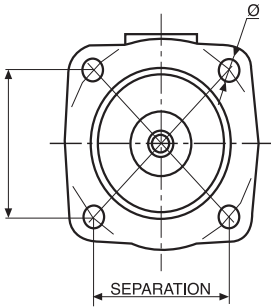

MASTER CYLINDER
TYPE

CMDD

